

- Contractors must check all dimensions on site. Only figured dimensions are to be worked from. Discrepancies must be reported to the Architect or Engineer before proceeding. © This drawing is copyright
- Reproduced from OS Sitemap © by permission of Ordnance Survey® on behalf of The Controller of Her Majesty's Stationary Office. © Crown copyright 2008. All rights reserved. Licence number 100007126.

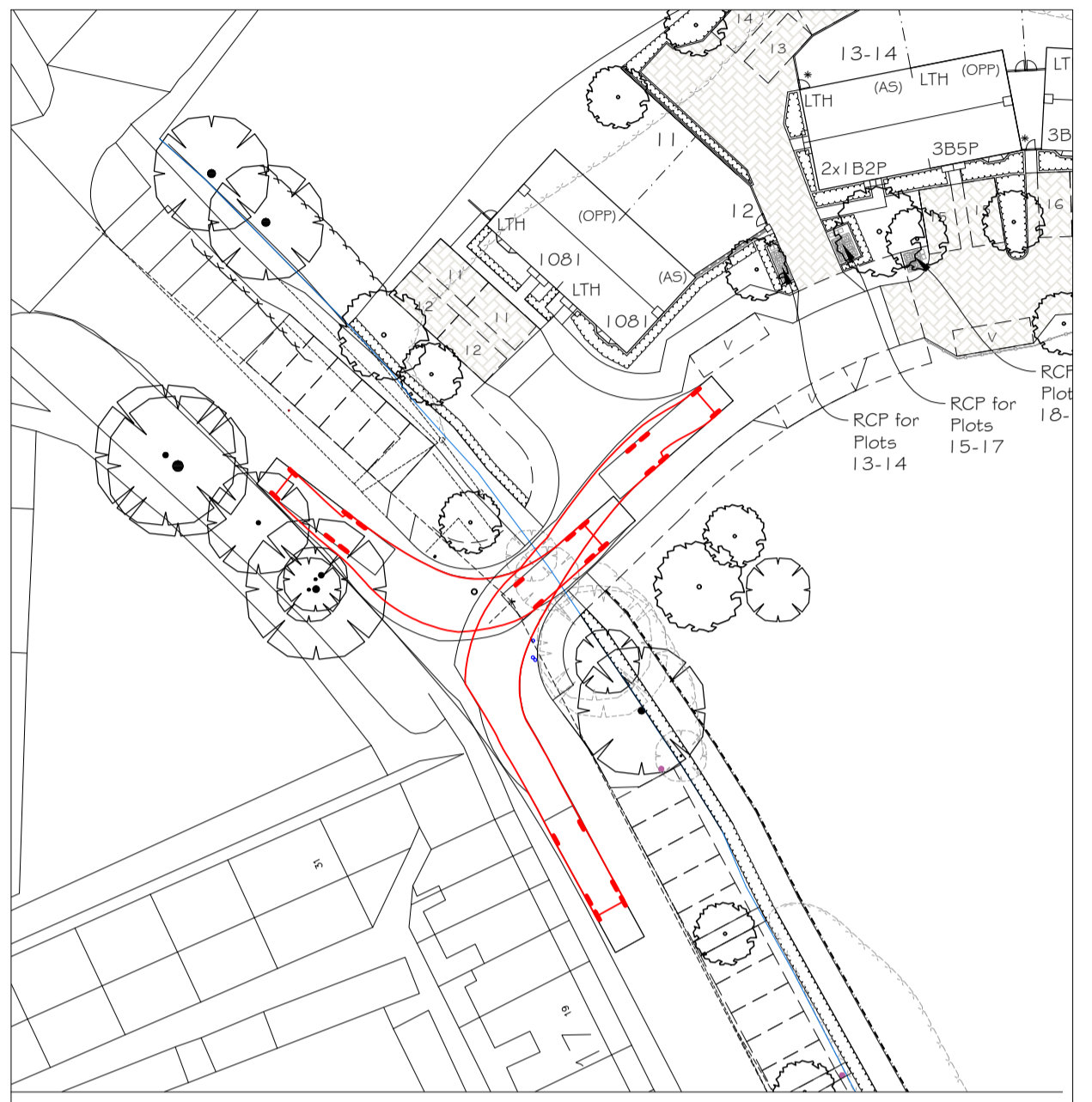

Additional Refuse Vehicle Tracking (entering and exiting northern access onto Hillfoot Road)

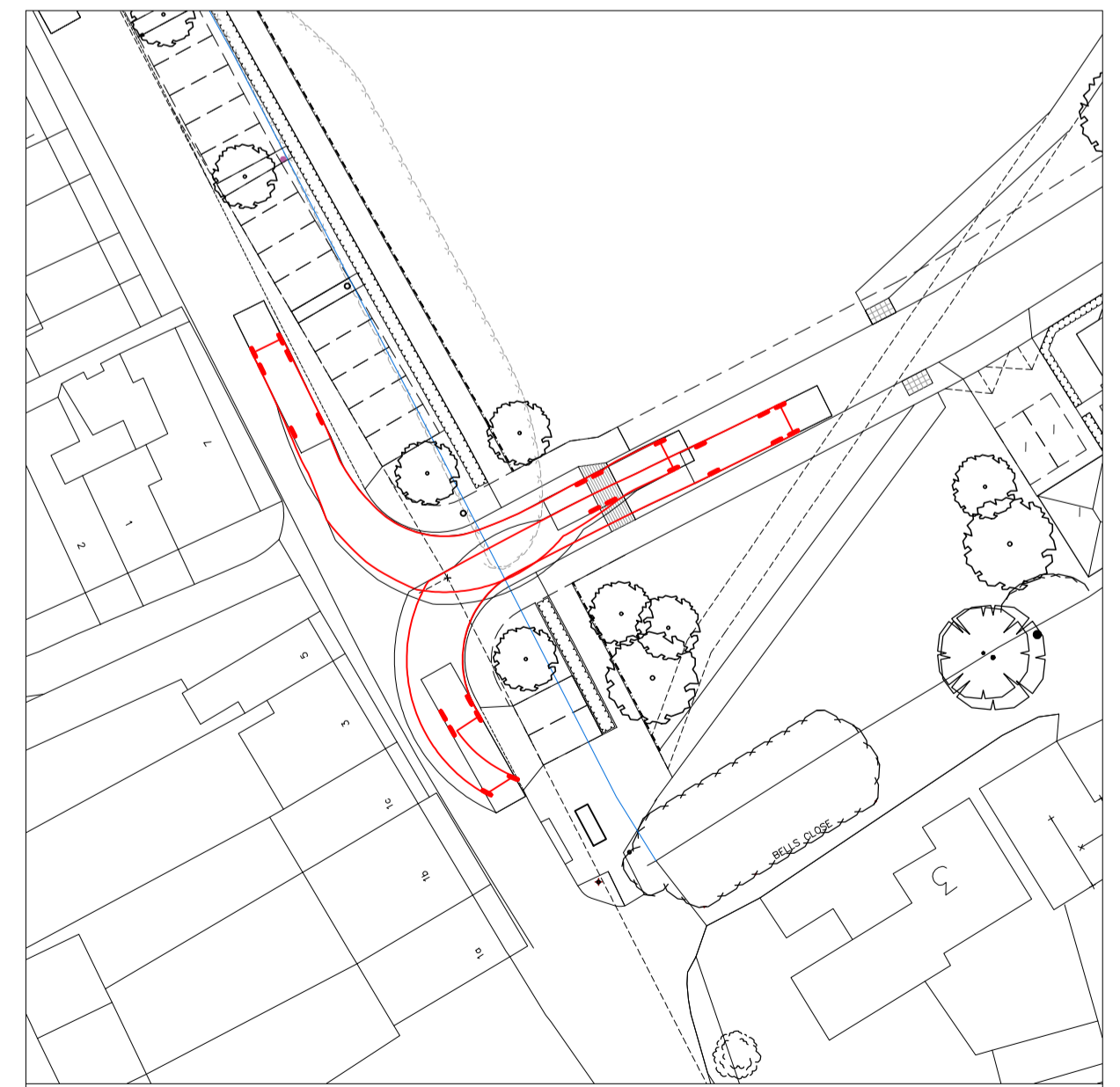

Additional Refuse Vehicle Tracking entering and exiting from southern access onto Hillfoot Road

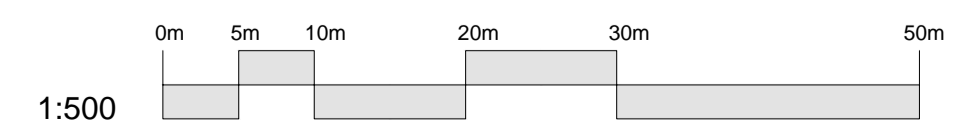
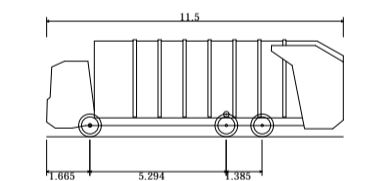

Diagram of Refuse Collection Vehicle for Tracking



Eagle Elite 2 6x4 (CBC Refuse)	
Overall Length	11.500m
Overall Width	2.530m
Overall Body Height	3.756m
Min Body Ground Clearance	0.309m
Track Width	2.530m
Lock-to-lock time	4.00s
Curb to Curb Turning Radius	11.550m

COMBINED REFUSE COLLECTION POINT FOR PRIVATE DRIVE

NOTE:- For dwellings fronting adoptable roads, 2 x refuse bins will be deposited at edge of adopted road on collection day.

Revision	Description	Drawn	Checked	Date
Preliminary	Information	Tender	Construction	As Built



Title **Land off Hillfoot Road Shillington**
 Details **Refuse Strategy Plan 19 Unit Scheme**
 Scale **1:500@A1** Date **July 2018** Drawn **CM** Chk **GS**

15-17 Goldington Road
 Bedford
 MK40 3NH
 United Kingdom
 T. +44 (0)1234 288862
 F. +44 (0)1234 353034
 mail@woodshardwick.com
 www.woodshardwick.com